



DEUTSCH

| DEUTSCH Common Contact, DEUTSCH DRC, DEUTSCH HD, DEUTSCH HDP, Jiffy Splice

TE Internal #: 0411-310-1605

Insertion & Extraction Tools, Contact Extraction, Contact-to-Housing, DEUTSCH HD

[View on TE.com >](#)

Application Tooling > Insertion & Extraction Tools

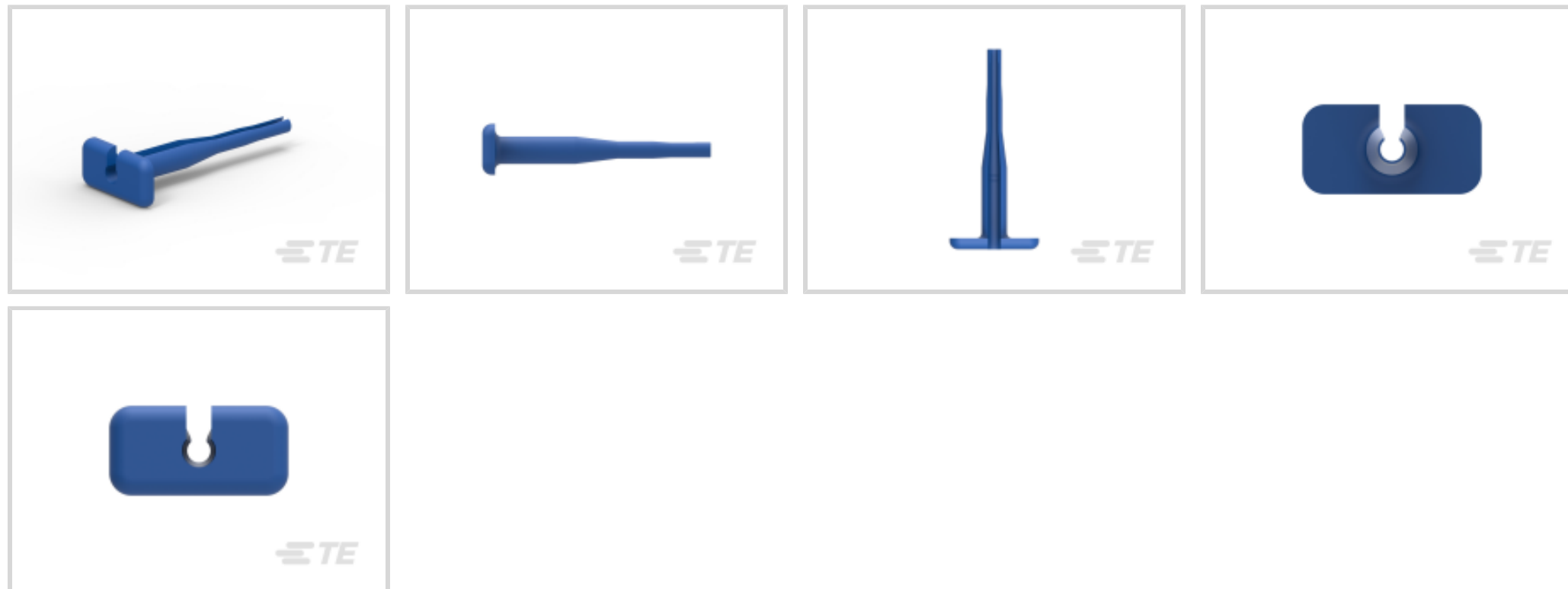

Insertion & Extraction Tool Type: **Contact Extraction**

Insertion & Extraction Tool Application: **Contact-to-Housing**

Features

Product Type Features

Insertion & Extraction Tool Type	Contact Extraction
Insertion & Extraction Tool Application	Contact-to-Housing

Contact Features

Contact Size	Size 16
--------------	---------

Product Compliance

[For compliance documentation, visit the product page on TE.com>](#)

EU RoHS Directive 2011/65/EU	Compliant
EU ELV Directive 2000/53/EC	Compliant
China RoHS 2 Directive MIIT Order No 32, 2016	No Restricted Materials Above Threshold
EU REACH Regulation (EC) No. 1907/2006	Current ECHA Candidate List: JUNE 2024 (241) Candidate List Declared Against: JAN 2024 (240) Does not contain REACH SVHC
Halogen Content	Low Halogen - Br, Cl, F, I < 900 ppm per homogenous material. Also BFR/CFR/PVC Free



Solder Process Capability

Not reviewed for solder process capability

Product Compliance Disclaimer

This information is provided based on reasonable inquiry of our suppliers and represents our current actual knowledge based on the information they provided. This information is subject to change. The part numbers that TE has identified as EU RoHS compliant have a maximum concentration of 0.1% by weight in homogenous materials for lead, hexavalent chromium, mercury, PBB, PBDE, DBP, BBP, DEHP, DIBP, and 0.01% for cadmium, or qualify for an exemption to these limits as defined in the Annexes of Directive 2011/65/EU (RoHS2). Finished electrical and electronic equipment products will be CE marked as required by Directive 2011/65/EU. Components may not be CE marked. Additionally, the part numbers that TE has identified as EU ELV compliant have a maximum concentration of 0.1% by weight in homogenous materials for lead, hexavalent chromium, and mercury, and 0.01% for cadmium, or qualify for an exemption to these limits as defined in the Annexes of Directive 2000/53/EC (ELV). Regarding the REACH Regulation, the information TE provides on SVHC in articles for this part number is based on the latest European Chemicals Agency (ECHA) 'Guidance on requirements for substances in articles' posted at this URL: <https://echa.europa.eu/guidance-documents/guidance-on-reach>

Compatible Parts



TE Part # CAT-H3930-CH8172
DEUTSCH HD30 Housings



TE Part # CAT-D799-CH8172
DEUTSCH DRC Housings



TE Part # CAT-H396-CH8172
DEUTSCH HDP20 Housings



TE Part # HD10-6-96P
SQ FG REC ASM



TE Part # JS-16-00
JIFFY SPLICE, Size 16



TE Part # CAT-D48-ST273
DEUTSCH Solid Contacts



TE Part # AEC16-40SBT-K001
PLG, 40P, BLK, T, BRN CAP, D



TE Part # AEC16-40SCT
PLG, 40P, BLK, T, C

Also in the Series | DEUTSCH Common Contact

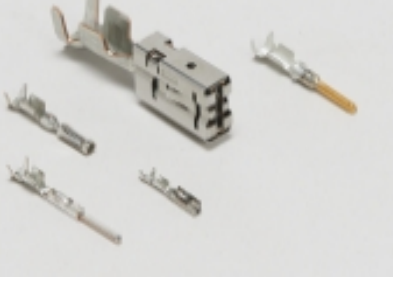

Automotive Terminals(91)



Insertion & Extraction Tools(8)

Also in the Series | DEUTSCH DRC



Automotive Housings(117)



Connector Backshells(6)



Connector Strain Relief(3)



Insertion & Extraction Tools(7)

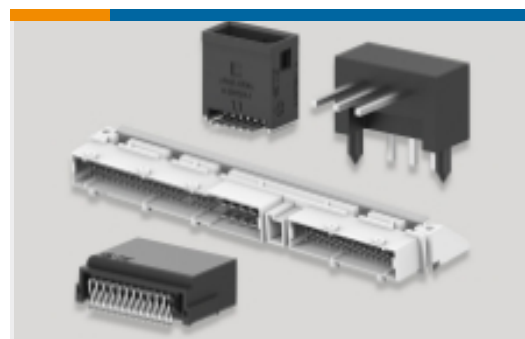

PCB Headers & Receptacles(44)

Also in the Series | DEUTSCH HD



Automotive Connector Caps & Covers (32)



Automotive Housings(768)



Connector Backshells(29)



Connector Seals & Cavity Plugs(10)



Connector Strain Relief(5)



Insertion & Extraction Tools(11)



Other Automotive Connector Accessories(11)

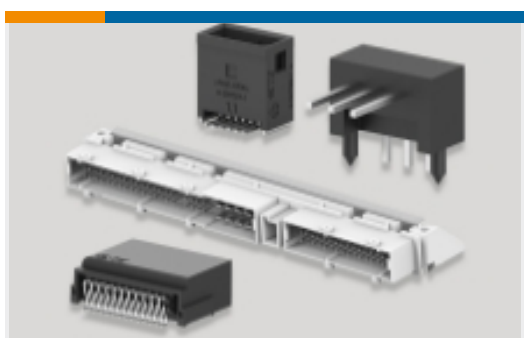

PCB Headers & Receptacles(1)

Also in the Series | DEUTSCH HDP



Automotive Connector Caps & Covers (4)

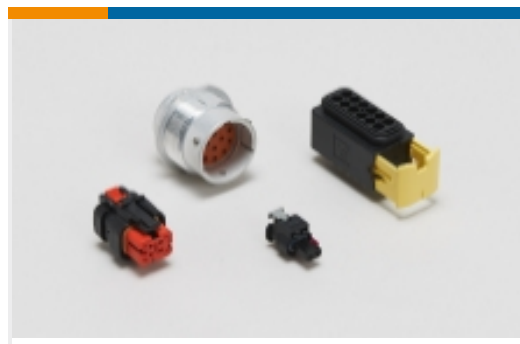

Automotive Housings(357)



Connector Backshells(8)



Connector Seals & Cavity Plugs(1)



Insertion & Extraction Tools(11)



Other Automotive Connector Accessories(5)

Also in the Series | Jiffy Splice



Insertion & Extraction Tools(1)



Other Automotive Connector Accessories(2)

Customers Also Bought



TE Part #DT-RT1
EXT TOOL, FRONT RELEASE



TE Part #0411-027-0405
EXT TOOL, SIZE 4, 4 AWG, N, BLK



TE Part #0411-353-0805
EXT TOOL, SIZE 8, 8-10 AWG, N, GRN



TE Part #0411-337-1205
EXT TOOL, SIZE 12, 12-14 AWG, E, ORG



TE Part #114009-ZZ
EXT TOOL, SIZE 4, 6 AWG, N, WHT



TE Part #114008-ZZ
EXT TOOL, SIZE 8, 8-10 AWG, N, GRN



TE Part #0411-204-1605
EXT TOOL, SIZE 16, 16-18 AWG, N, DRK BLU

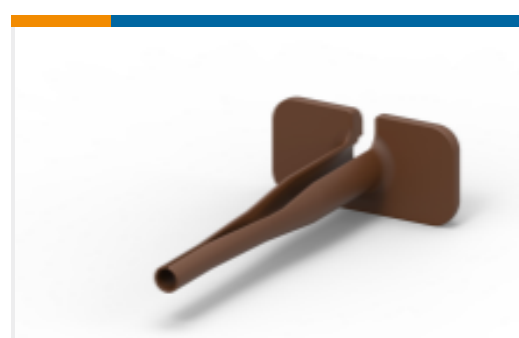

TE Part #0411-354-1605
EXT TOOL, SIZE 16, 16-18 AWG, N, BRN

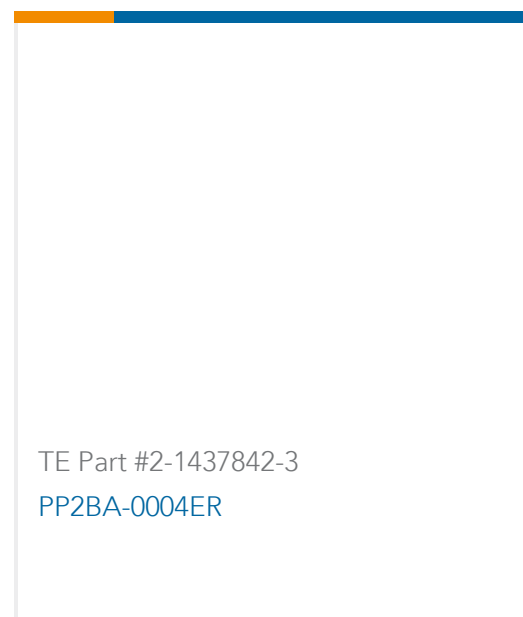

Documents

Product Drawings

[EXT TOOL, SIZE 16, 16-18 AWG, T, LT BLU](#)

English

CAD Files

[3D PDF](#)

3D

[Customer View Model](#)

[ENG_CVM_CVM_0411-310-1605_G.2d_dxf.zip](#)

English

[Customer View Model](#)

[ENG_CVM_CVM_0411-310-1605_G.3d_igs.zip](#)

English

[Customer View Model](#)

[ENG_CVM_CVM_0411-310-1605_G.3d_stp.zip](#)

English

By downloading the CAD file I accept and agree to the [Terms and Conditions](#) of use.

Datasheets & Catalog Pages

[CONNECTOR SELECTOR](#)

English

Instruction Sheets

[Instruction Sheet \(U.S.\)](#)

English